



Flat 7 Doddington Court, Wellingborough, NN8 2LE

£725 PCM







# Flat 7 Doddington Court

Wellingborough, NN8 2LE

- Newly Refurbished
- Double glazing
- Refitted Bathroom
- Allocated Parking
- Smart Refitted Kitchen
- Quality Floor Coverings

Situated on Doddington road in Wellingborough is this 1 bedroom second floor flat which is presented in excellent condition. The property has been completely refurbished in only the last few weeks and benefits from: Stylish refitted kitchen, refitted bathroom, smart interior decor and top class floor coverings. This well presented accommodation consists of: Communal entrance, entrance hall, lounge, kitchen/diner, double bedroom and good size bathroom. Further features include sealed unit double glazing and an allocated parking space. View now to appreciate what is on offer here!

Viewing is highly recommended to avoid disappointment.



## Entrance Hall

## Lounge

13'2" x 10'5" (4.01 x 3.18)

## Kitchen/Diner

13'11" x 7'8" (4.24 x 2.34)

## Bedroom

12'1" x 10'11" (3.68 x 3.33)

## Bathroom





**Directions**





Floor Plans

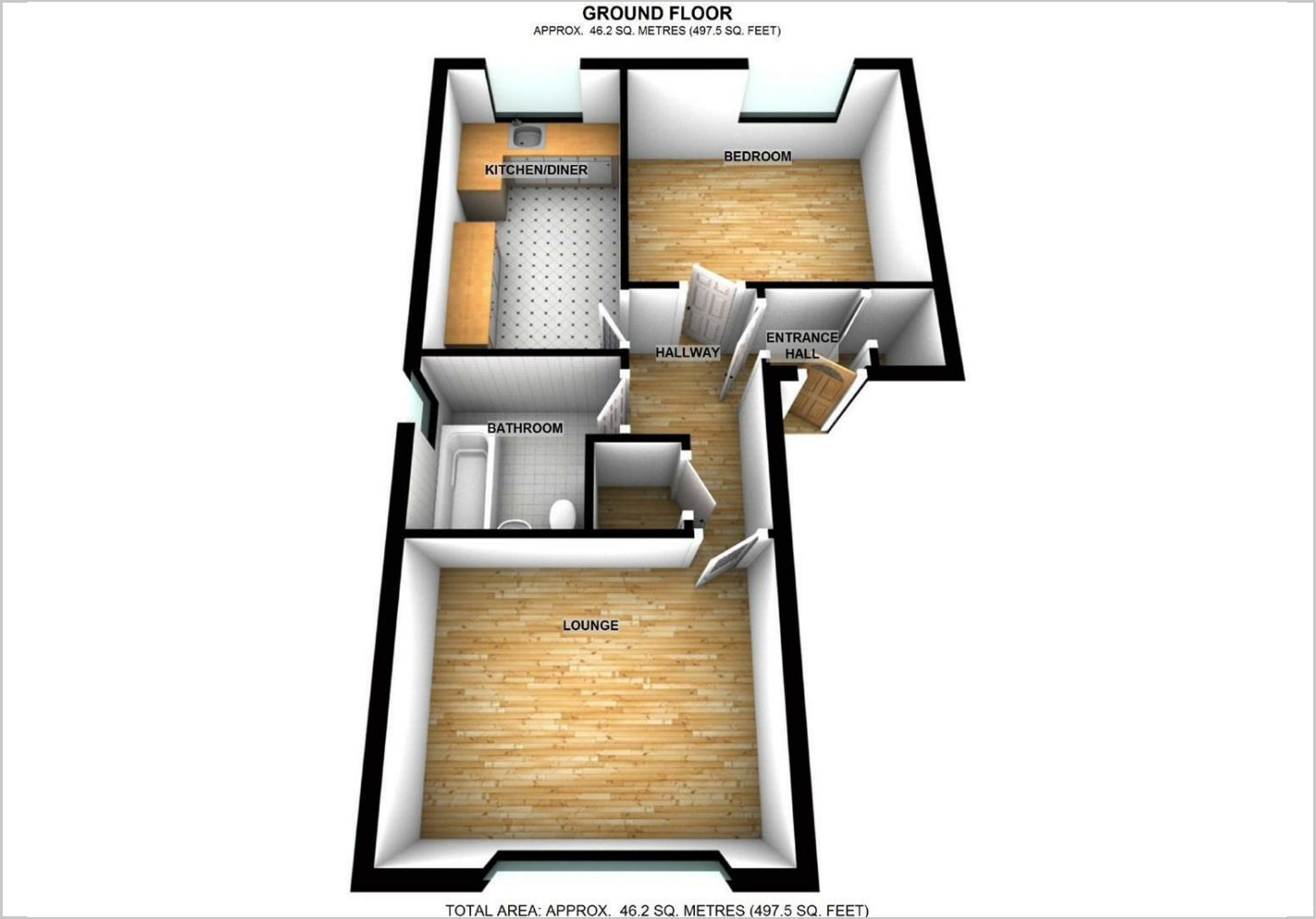

Viewing

Please contact our Wellingborough Office on 01933 224444 if you wish to arrange a viewing appointment for this property or require further information.

The particulars are set out as a general outline only for the guidance of intended purchasers or lessees, and do not constitute, any part of a contract. Nothing in these particulars shall be deemed to be a statement that the property is in good structural condition or otherwise nor that any of the services, appliances, equipment or facilities are in good working order. Purchasers should satisfy themselves of this prior to purchasing.

Location Map

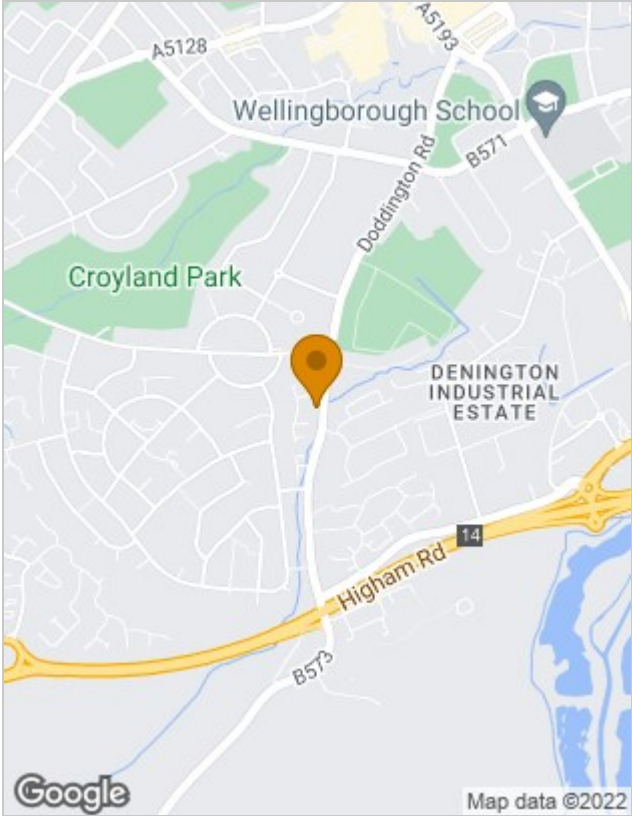

Energy Performance Graph

